

(EN) Assembly instructions

(DE) Montageanleitung

(FI) Kokoonpano-ohjeet

(HR) Skupština Upute

(FR) Notice de Montage

(IT) Istruzioni di Montaggio

(BS) Skupština Uputstvo

(NL) Montage Instructies

(CS) Montážní Návod

(RO) Instrucțiuni de Asamblare

(DA) Montagevejledning

(PL) Instrukcja Montażu

(RU) Инструкция по Монтажу

(SV) Monteringsanvisning

(SL) Navodila za Montažo

(UK) Інструкція по монтажу

(NO) Montasjeveiledning

(HU) Szerelési útmutató

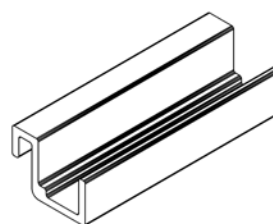
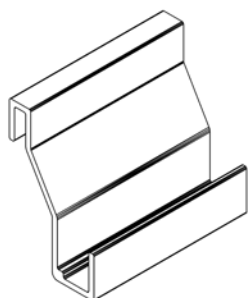
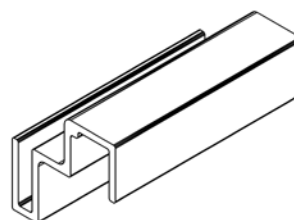
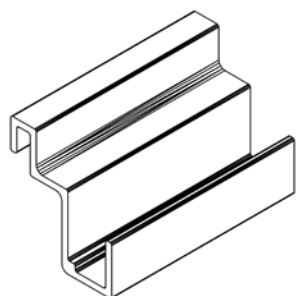
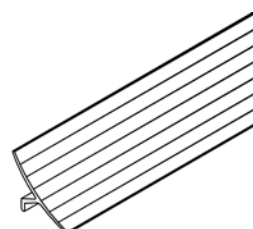
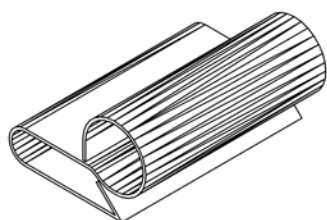

Vitavía
- makes living grow

VA0001-W

PART LIST

VA0001-W Pack 1		(mm)	TOTAL	VM0036-AP 2500	VM0036-AP 3800	VM0024-V 2500, VM0025-C 3000	VM0024-V 3800, VM0025-C VM0049-CS 4400	Part No. 4mm (20500)	Part No. 6mm (20506)	(X) = cut/schneide X 
1	Z1	30	11x	9x	11x	9x	11x	1311	1315	
2	Z2	30	6x	4x	6x	4x	6x	1312	1316	
3	Z3	30	7x	7x	7x	7x	7x	1313	1317	
4	Z4	30	6x	4x	6x	4x	6x	1314	1318	
5	2399	20	5x	3x	5x	3x	5x	2399		

6	h2	344	2x	2x	2x	(2x) °	(2x) °	6611	° = 230mm	
7	h3	610	6x	6x	6x	6x	6x	6605		
8	h5	1132	14x	10x	14x	10x	14x	6610		
9	h6	1213	16x	12x	16x	12x	16x	6609		
10	h7	1660	6x	6x	6x	6x	6x	6608		

VA0001-W Pack 2		(mm)	TOTAL	VM0036-AP 5000	VM0037-AP 6200	VM0024-V VM0047-VS 5000, VM0004-C VM0050-CS 5800	VM0005-V VM0048-VS 6200, VM0004-C 7300	Part No. 4mm (20501)	Part No. 6mm (20507)	(X) = cut/schneide X 
1	Z1	30	15x	13x	15x	13x	15x	1311	1315	
2	Z2	30	10x	8x	10x	8x	10x	1312	1316	
3	Z3	30	8x	7x	8x	7x	8x	1313	1317	
4	Z4	30	10x	8x	10x	8x	10x	1314	1318	
5	2399	20	8x	7x	8x	7x	8x	2399		

6	h2	344	2x	2x	2x	(2x) °	(2x) °	6611	° = 230mm	
7	h3	610	8x	6x	8x	6x	8x	6605		
8	h5	1132	20x	18x	20x	18x	20x	6610		
9	h6	1213	24x	20x	24x	20x	24x	6609		
10	h7	1660	6x	6x	6x	6x	6x	6608		

PART LIST

VA0001-W Pack 3		(mm)	TOTAL	VM0002-MN / VM0011-MN+ 6700	VM0001-UJ / VM0035-P 6700	VM0037-AP / VM0005-V VM0048-VS 7500	Part No. 4mm (20502)	Part No. 6mm (20508)	(X) = cut/schneide X 
1	Z1	30	17x	15x / 14x	14x	17x	1311	1315	
2	Z2	30	12x	8x	8x	12x	1312	1316	
3	Z3	30	14x	8x / 14x	14x	8x	1313	1317	
4	Z4	30	12x	8x	8x	12x	1314	1318	
5	2399	20	10x	6x	6x	10x	2399		

6	h1	425	4x	4x	4x	-	6607		
7	h2	588	4x	$(2x / 4x)^*$	$(4x)^2 / 4x$	$(2x)^3 / (2x)^\circ$	6606		² = 540mm, [*] = 379 mm, ³ = 344 mm, [°] = 230 mm
8	h3	610	8x	4x / 8x	8x	8x	6605		
9	h4	970	4x	4x	4x	-	6603		
10	h5	1132	24x	-	-	24x	6610		
11	h5/6	1509	36x	$16x+(20x)^*$	36x	$(28x)^\circ$	6602		[*] = 1350 mm, [°] = 1213 mm
12	h7	1960	10x	$(10x / 8x)^*$	8x	$(6x)^\circ$	6601		[*] = 1796 mm, [°] = 1660 mm

VA0001-W Pack 4		(mm)	TOTAL	VM0002-MN / VM0011-MN+ 8300	VM0002-MN / VM0011-MN+ 9900	VM0002-MN / VM0011-MN+ 11500	VM0001-UJ / VM0035-P 8300	VM0001-UJ / VM0035-P 9900	VM0001-UJ / VM0035-P 11500	Part No. 4mm (20503)	Part No. 6mm (20509)	(X) = cut/ schneide X 
1	Z1	30	21x	17x / 16x	19x / 18x	21x / 20x	16x	18x	20x	1311	1315	
2	Z2	30	14x	10x	12x	14x	10x	12x	14x	1312	1316	
3	Z3	30	16x	8x / 14x	8x / 14x	8x / 14x	16x	16x	16x	1313	1317	
4	Z4	30	14x	10x	12x	14x	10x	12x	14x	1314	1318	
5	2399	20	12x	8x	10x	12x	6x	8x	10x	2399		

6	h1	425	4x	4x	4x	4x	4x	4x	4x	6607		
7	h2	588	4x	$(2x / 4x)^*$	$(2x / 4x)^*$	$(2x / 4x)^*$	$(4x)^2 / 4x$	$(4x)^2 / 4x$	$(4x)^2 / 4x$	6606		² = 540mm, [*] = 379 mm
8	h3	610	8x	4x / 8x	4x / 8x	4x / 8x	8x	8x	8x	6605		
9	h4	970	8x	4x	4x	4x	8x	8x	8x	6603		
10	h5/6	1509	60x	$20x+(24x)^*$	$24x+(28x)^*$	$28x+(32x)^*$	40x	48x	56x	6602		[*] = 1350 mm
11	h7	1960	10x	$(10x / 8x)^*$	$(10x / 8x)^*$	$(10x / 8x)^*$	8x	8x	8x	6601		[*] = 1796 mm

1

VM0004-C / VM0005-V / VM0024-V / VM0025-C
 / VM0036-AP / VM0037-AP / VM0047-V
 / VM0048-VS / VM0049-CS / VM0050-CS

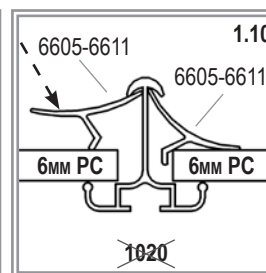
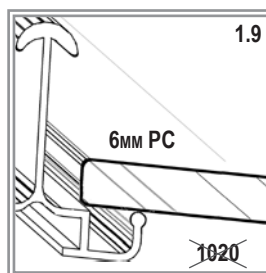
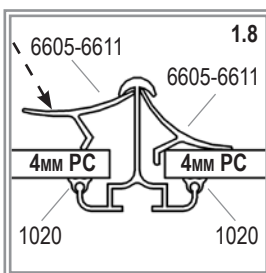
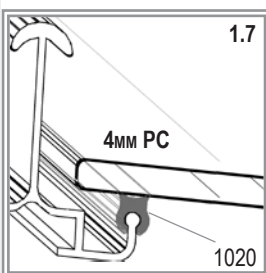
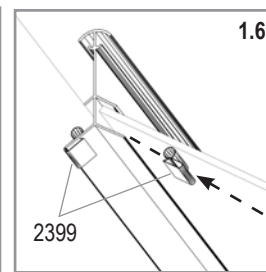
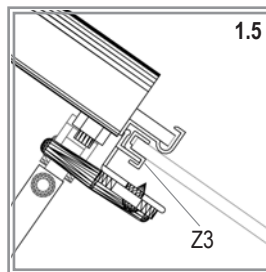
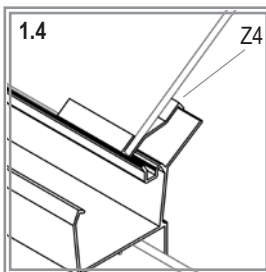
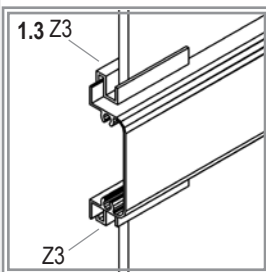
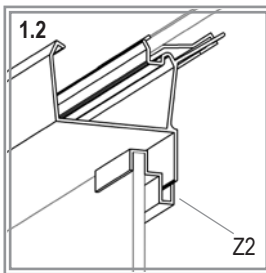
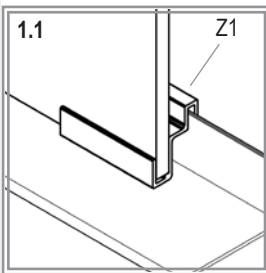
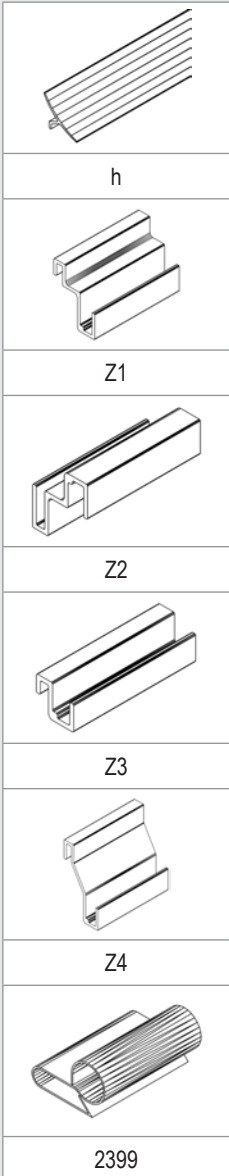
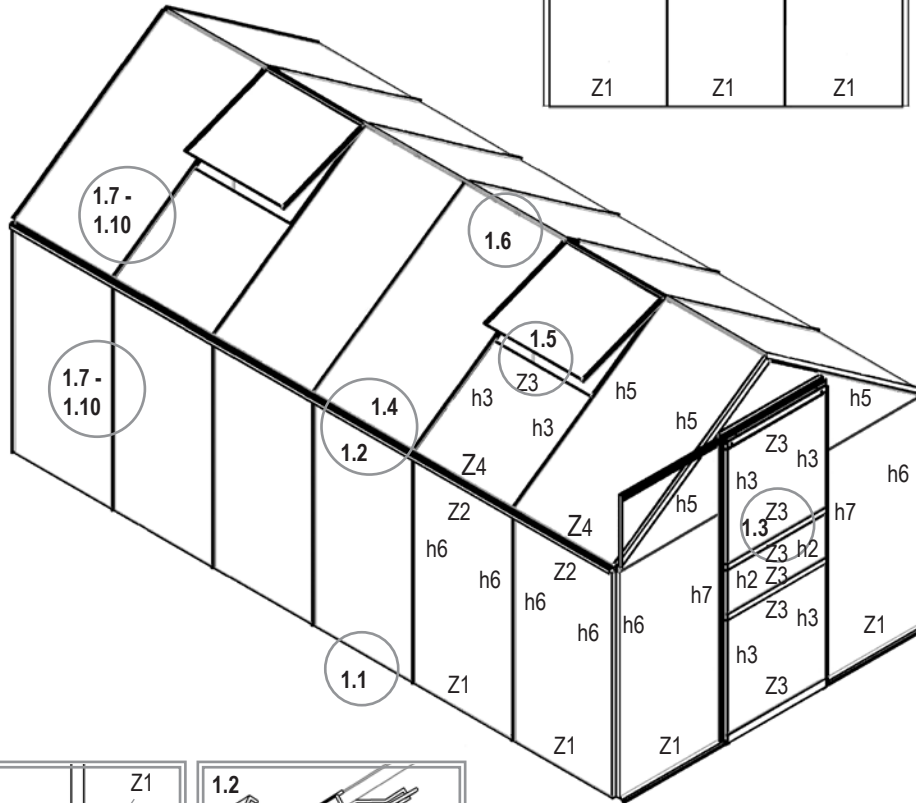
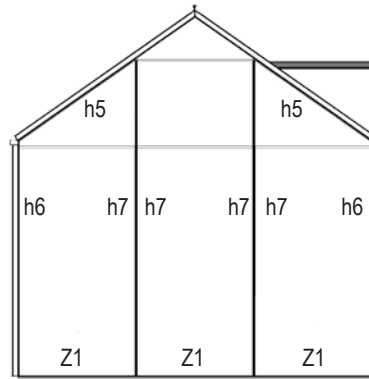

VA0001-W



E.P.H. Schmidt u. Co. GmbH
Hoefkerstrasse 30
44149 Dortmund
Postfach 170163
44060 Dortmund
Deutschland
Tel.: +49 231 941655 0
Fax: +49 231 941655 99
www.eph-schmidt.de
verkauf@eph-schmidt.de

OPJ A/S
Volderslevvej 36 A
5260 Odense S
Danmark
Tel.: +45 66 15 10 30
Fax: +45 66 15 00 84
www.opj.dk
opj@opj.dk